

***TELIKOU* Intercom System**

BK-803 Listening Belt Pack

Instruction Manual

© 2006 **TELIKOU Systems**

All Rights Reserved

www.telikou.com

While **TELIKOU** makes every attempt to maintain the accuracy of the information contained in

its product manuals, that information is subject to change without notice

● **Introduction**

Thank you for choosing TELIKOU intercom product. BK-803 listening belt pack can work with any TELIKOU Intercom standard main station. This listening belt pack is used for announcer, program guests and other similar situations.

This system adopts wired connection, and has following features, balance or unbalance selection, stable and reliable performance, full-duplex communication, clear and loud communication sound, easy operation, and strong noise resistance.

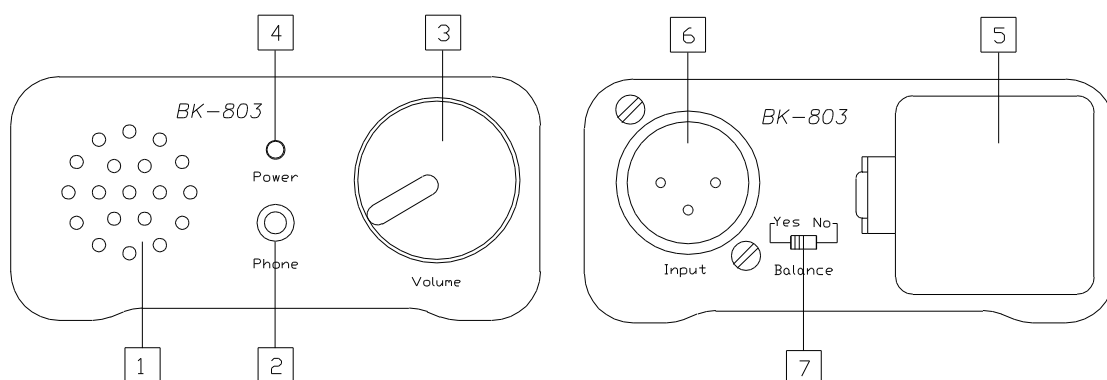

● **Basic operation**

1. Panel Speaker

Panel speaker works when earphone is not been connected.

2. Earphone Jack

3.5mm earphone jack

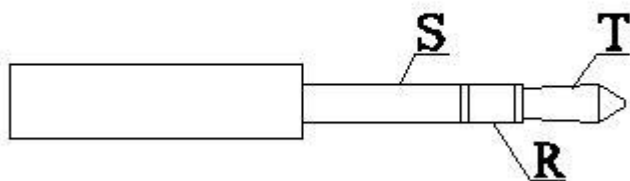

T (Tip)	---	Null
R (Ring)	---	Hot
S (Sleeve)	---	Common

3. Power Switch and Volume

Switch with knob. This knob is used to control the audio signal level which received through intercom line. It also can be used to adjust the volume of earphone. Turn the switch anticlockwise completely will turn the unit off. When unit is not being used, please turn it off. Especially when using battery to supply power.

4. Power and Low Voltage Indicator

Green LED indicates voltage is normal. Red LED indicates battery voltage is low.

5. Battery

BK-803 uses four AA size batteries. When using AA size battery if voltage is lower than 5V, Power and Low Voltage Indicator will become red.

6. Audio Signal Connector

XLR-3M connector. Pin out configuration is different when Balance Selection Switch (No.7) at different position.

A) Balance Selection Switch at 'NO'

Pin 1 -- Common

Pin 2 – DC Power (15V-30V)

Pin 3 – Audio Signal

When connect to intercom system, BK-803 receives power on Pin2 from main station.

When connect to external audio signal, Bk-803 can be powered by battery. Meanwhile Pin2 is Null. For example, when BK-803 is connected to a cell phone, Pin1 connect to cell phone's earphone jack common. Pin3 connect to cell phone's earphone jack hot. Pin2 is block-condenser.

B) Balance Selection Switch at 'YES'

Pin 1 -- Common

Pin 2 – Audio Signal +

Pin 3 – Audio Signal –

When balanced input is selected, BK-803 only can be powered by battery.

7. Balance Selection Switch

When this switch is set as 'NO', audio connector (No.6) is working as unbalanced audio connector.

Pin 1 -- Common

Pin 2 – DC Power (15V-30V)

Pin 3 – Audio Signal

When switch is set as 'YES', audio connector (No.6) is working as balanced audio connector.

Pin 1 -- Common

Pin 2 – Audio Signal +

Pin 3 – Audio Signal –

● Troubleshooting

Problem: No voice from earphone

Cause: Wrong earphone wiring. For example, using mono earphone may cause audio signal short.

Solution: Change earphone connector wiring followed by the manual

● Specifications

Input impedance: 10K ohm

Load impedance: 8-32 ohm

Bandwidth: 200Hz-8000Hz \pm 2dB

SNR: >72dB

Power assumes:

Static states: <12mA

Working States: < 200mA

Voltage:

Intercom Line: 15-30 volts DC

Battery: 6-9 volts DC

Environment: 0~70°C

Dimension: 105mm x 87mm x 48mm